

Last information update: March 2025

Product configuration: EN23+GOBO30B

EN23: Ø 116mm spotlight with Profiler – Warm White LED

GOBO30B: Gobo ø30mm - min focusing

**Product code**

EN23: Ø 116mm spotlight with Profiler – Warm White LED

Technical description

Spotlight for outdoor use with profiler designed to use LED lamps. Consists of an optical assembly and a base. The optical assembly, arm and base and frame holder are made of aluminium alloy and subjected to a multi-step, pre-treatment process, in which the main phases are degreasing, fluorozirconation (a protective surface film) and sealing (with a nano-structured silane layer). The painting stage consists of a primer and a liquid acrylic paint, cured at 150 °C, with a high level of weather resistance. 5 mm thick extra-clear tempered sodium-calcium closing glass. Secured using a 360° adjustable base. Adjustable horizontally. Includes a graduated scale with a position lock. Complete with LED circuit and Opti Beam optic system. The product is supplied with Ø40mm and Ø30mm gobos that allow 26° and 18° light cones and blades to define specific magnetically mountable forms. The chance to use dichroic glass gobos (via assembly with a gobo holder and an image rotation system) or in sheet metal (via a magnetic assembly). The product includes a PG9 cable gland. Electronic DALI ballast integrated in product. Option of installing a SPD to increase voltage spike protection. All external screws used are made of A2 stainless steel.

Installation

Floor, wall, ceiling or ground-installed via a stake.

Colour

White (01) | Black (04) | Grey (15) | Rust Brown (F5)

Weight (Kg)

5.45

Wiring

Double PG.

Notes

Voltage spike protection: 2kV Common Mode and 1kV Differential Mode.

Complies with EN60598-1 and pertinent regulations



IK07

IP66

**Technical data**

Im system:	1035	Lamp code:	LED
W system:	34.6	Number of lamps for optical assembly:	1
Im source:	3980	ZVEI Code:	LED
W source:	30	Number of optical assemblies:	1
Luminous efficiency (Im/W, real value):	29.9	Intervalllo temperatura ambiente:	from -20°C to +35°C. (*)
Im in emergency mode:	-	Power factor:	See installation instructions
Total light flux at or above an angle of 90° [Lm]:	0	Inrush current:	20 A / 50 µs
Light Output Ratio (L.O.R.) [%]:	26	Maximum number of luminaires of this type per miniature circuit breaker:	B10A: 34 luminaires B16A: 55 luminaires C10A: 57 luminaires C16A: 93 luminaires
CRI (minimum):	80	Minimum dimming %:	1
Colour temperature [K]:	2700	Overvoltage protection:	2kV Common mode & 2kV Differential mode
MacAdam Step:	2	Control:	DALI-2
Life Time LED 1:	100,000h - L90 - B10 (Ta 25°C)		

* Preliminary data

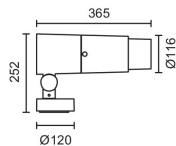

Polar

