

Last information update: September 2024

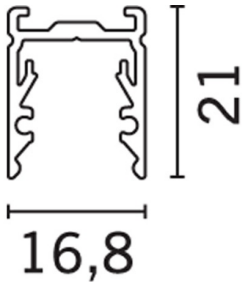
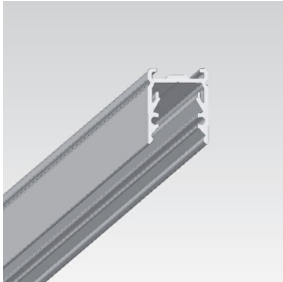

Product code

MXL2: High surface linear profile for Ledstrip Top - L=1000

Technical description

Rigid frameless aluminium profile for surface installation (high version); the shape of the profile allows application of all monochrome Ledstrips with front emission LEDs, available in standard version (with adhesive) or tube version (with outer sheath). Finishes available: anodised grey - white. The profile may be completed with a diffuser screen available with two finishes: opal and translucent. The raised section of the profile, coupled with the opal diffuser screen, eliminates the pinpoint effect typical of strips.

Installation

surface-mounted; direct fixing with screws (not included); the profile has a longitudinal guide to facilitate drilling. For challenging installations, a kit of accessory clips is available (code MXM4 x 5 pcs); with preliminary fixing of the clips using screws, then profile snap-in anchoring on the clips prepared (screws not included). Accessory closing end caps (code MXL9 - kit 2 x 5 pcs).

Colour

White (01) | Aluminium (12)

Weight (Kg)

0.25

Mounting

wall surface|ceiling surface

Wiring

Carefully read the Ledstrip instructions sheet

Notes

Carefully read the Ledstrip instructions sheet

Complies with EN60598-1 and pertinent regulations

850°C