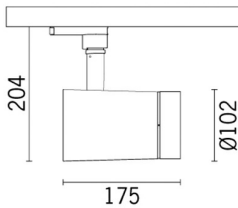

Last information update: April 2025

**Product configuration: P604**

P604: small body - warm white ssp 7° optic

**Product code**

P604: small body - warm white ssp 7° optic

**Technical description**

Adjustable spotlight with adapter for installation on a mains voltage track. Luminaire made of die-cast aluminium. Spotlight double adjustability allows a 360° rotation about the vertical axis and 90° tilting relative to the horizontal plane. Mechanical aiming locks both for rotation about the vertical axis and tilting relative to the horizontal plane. Optical assembly made up of Warm White colour tone 3000K high CRI C.o.B LED with OPT1 BEAM LENS technology with a well-defined superspot light beam. Electronic ballast integrated in the cylinder.

**Installation**

On an electrified track or base

**Colour**

White (01) | Black (04)

**Weight (Kg)**

1.45

**Mounting**

three circuit track

**Wiring**

Product complete with electronic components

Complies with EN60598-1 and pertinent regulations

**Technical data**

|  |      |  |  |
|--|------|--|--|
| lm system:   | 292  | Life Time LED 1:   | > 50,000h - L80 - B10 (Ta 25°C)  |
| W system:  | 8.5  | Lamp code:   | LED  |
| lm source:   | 540  | Number of lamps for optical assembly:                                    | 1  |
| W source:  | 5.6  | ZVEI Code:   | LED  |
| Luminous efficiency (lm/W, real value):            | 34.3 | Number of optical assemblies:  | 1  |
| lm in emergency mode:                              | -    | Power factor:  | See installation instructions  |
| Total light flux at or above an angle of 90° [Lm]: | 0    | Inrush current:  | 5 A / 50 µs  |
| Light Output Ratio (L.O.R.) [%]:                   | 54   | Maximum number of luminaires of this type per miniature circuit breaker: | B10A: 31 luminaires<br>B16A: 50 luminaires<br>C10A: 52 luminaires<br>C16A: 85 luminaires |
| Beam angle [°]:                                    | 8°   | Minimum dimming %:   | 1  |
| CRI (minimum):                                     | 90   | Overvoltage protection:  | 4kV Common mode & 2kV Differential mode  |
| Colour temperature [K]:                            | 3000 | Control:   | Completo di dimmer   |
| MacAdam Step:                                      | 2    |  |  |

**Polar**

| Imax=10821 cd | Lux |     |      |      |
|---------------|-----|-----|------|------|
|               | h   | d   | Em   | Emax |
|               | 2   | 0.3 | 2120 | 2705 |
|               | 4   | 0.6 | 530  | 676  |
|               | 6   | 0.9 | 236  | 301  |
|               | 8   | 1.2 | 133  | 169  |

Utilisation factors

| R    | 77 | 75 | 73 | 71 | 55 | 53 | 33 | 00 | DRR |
|------|----|----|----|----|----|----|----|----|-----|
| K0.8 | 48 | 46 | 44 | 42 | 45 | 43 | 43 | 41 | 77  |
| 1.0  | 50 | 48 | 46 | 45 | 47 | 46 | 46 | 44 | 81  |
| 1.5  | 53 | 51 | 50 | 49 | 51 | 49 | 49 | 47 | 87  |
| 2.0  | 55 | 53 | 52 | 51 | 53 | 52 | 51 | 50 | 92  |
| 2.5  | 56 | 55 | 54 | 53 | 54 | 53 | 53 | 51 | 95  |
| 3.0  | 57 | 56 | 55 | 55 | 55 | 54 | 54 | 52 | 97  |
| 4.0  | 57 | 57 | 56 | 56 | 56 | 55 | 55 | 53 | 99  |
| 5.0  | 58 | 57 | 57 | 57 | 56 | 56 | 55 | 54 | 100 |

Luminance curve limit

