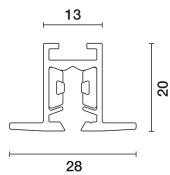

Last information update: April 2025

**Product code**

PT54: Frame recessed LV FILORAIL 48V (16A) track L=500

Technical description

Low voltage 48V (16A) track with a perimeter surface frame (Frame version). Designed to house dedicated lighting elements fitted with a specific 48V adapter. Made of painted extruded aluminium, it includes a series of assembly plates designed to allow profiles to be installed in false ceilings with different thicknesses. The integrated circuit, designed to interact with the DC/DC driver included in the adapters or products, allows the lighting elements inserted in the track to be programmed individually. To obtain continuous lines, direct and corner joints are available with separate codes. A sealing sheath is included that is positioned flush with the track opening to guarantee a clean cut and protection from scrap/dust.

Installation

Ceiling or wall-recessed. For the height of the false ceilings, see the instruction sheet.

Colour

White (01) | Black (04)

Mounting

Low voltage track

Wiring

A remote power supply is available with separate code. For maximum load details and cabling procedures see the instruction sheet.

Complies with EN60598-1 and pertinent regulations



IP20

