

View Opti Beam Lens round

Design iGuzzini /
Arup

iGuzzini

Last information update: May 2024

Product configuration: Q312

Q312: round large body spotlight - spot

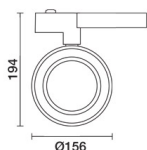

Product code

Q312: round large body spotlight - spot

Technical description

Indoor adjustable spotlight with adapter for installation on a three-phase/DALI track. Device made of die-cast aluminium and a front part made of a thermoplastic material. Spotlight double adjustability allows a 360° rotation about the vertical axis and 90° tilting relative to the horizontal plane. Optical assembly consisting of Warm White tone 3000K CRI90 LEDs with OPTIBEAM LENS technology and a well-defined spot light beam. Dimmable DALI driver built-in to box with a semi-hidden system on track. Option of installing a range of flat accessories including an OPTIBEAM REFRACTOR for varying light distribution, an elliptical distribution refractor, a louver, a soft lens and an outdoor accessory like an asymmetric visor for eliminating stray light dispersion on the ceiling.

Installation

On a three-phase/DALI electrified track

Colour

Black (04) | Black / White (47)

Weight (Kg)

1.66

Mounting

dali track|three circuit track

Wiring

Product complete with DALI dimmable components, housed in a semi-hidden box on the track.

Complies with EN60598-1 and pertinent regulations



IP20



Technical data

Im system:	2749	Colour temperature [K]:	3000
W system:	29.2	MacAdam Step:	2
Im source:	3160	Life Time LED 1:	> 50,000h - L90 - B10 (Ta 25°C)
W source:	24	Lamp code:	LED
Luminous efficiency (Im/W, real value):	94.2	Number of lamps for optical assembly:	1
Im in emergency mode:	-	ZVEI Code:	LED
Total light flux at or above an angle of 90° [Lm]:	0	Number of optical assemblies:	1
Light Output Ratio (L.O.R.) [%]:	87	Power factor:	See installation instructions
Beam angle [°]:	16°	Overvoltage protection:	2kV Common mode & 1kV Differential mode
CRI (minimum):	90	Control:	DALI-2

Polar

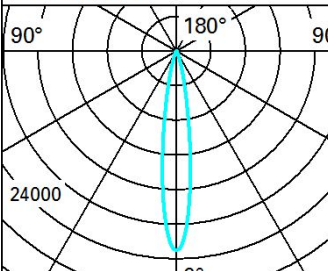
Imax=23024 cd		Lux			
	180°	h	d	Em	E _{max}
	90°	2	0.6	4473	5756
	24000	4	1.1	1118	1439
	0°	6	1.7	497	640
	$\alpha = 16^\circ$	8	2.2	280	360