

View Opti Beam Lens round

Design iGuzzini /
Arup

iGuzzini

Last information update: May 2024

Product configuration: Q301

Q301: round large body spotlight - super spot

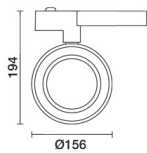

Product code

Q301: round large body spotlight - super spot

Technical description

Indoor adjustable spotlight with adapter for installation on a three-phase/DALI track. Device made of die-cast aluminium and a front part made of a thermoplastic material. Spotlight double adjustability allows a 360° rotation about the vertical axis and 90° tilting relative to the horizontal plane. Optical assembly consisting of Warm White tone 3000K CRI90 LEDs with OPTIBEAM LENS technology and a well-defined super spot light beam. Dimmable electronic driver built-in to box with a semi-hidden system on track. Option of installing a range of flat accessories including an OPTIBEAM REFRACTOR for varying light distribution, an elliptical distribution refractor, a louver, a soft lens and an outdoor accessory like an asymmetric visor for eliminating stray light dispersion on the ceiling.

Installation

On a three-phase/DALI electrified track

Colour

Black (04) | Black / White (47)

Weight (Kg)

1.66

Mounting

dali track|three circuit track

Wiring

Product complete with dimmable electronic components, housed in a semi-hidden box on the track.

Complies with EN60598-1 and pertinent regulations



Technical data

Im system:	501	Colour temperature [K]:	3000
W system:	16.8	MacAdam Step:	2
Im source:	910	Life Time LED 1:	> 50,000h - L80 - B10 (Ta 25°C)
W source:	12	Lamp code:	LED
Luminous efficiency (Im/W, real value):	29.8	Number of lamps for optical assembly:	1
Im in emergency mode:	-	ZVEI Code:	LED
Total light flux at or above an angle of 90° [Lm]:	0	Number of optical assemblies:	1
Light Output Ratio (L.O.R.) [%]:	55	Power factor:	See installation instructions
Beam angle [°]:	4°	Overvoltage protection:	2kV Common mode & 1kV Differential mode
CRI (minimum):	90	Control:	Push Dim

Polar

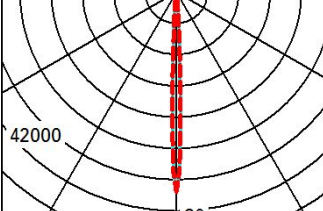
Imax=38248 cd		C0-180		Lux				
90°	180°	90°	h	d1	d2	Em	Emax	
			2	0.1	0.1	7606	9562	
			4	0.3	0.3	1902	2391	
			6	0.4	0.4	845	1062	
			8	0.6	0.6	475	598	
α=4°								

Utilisation factors

R	77	75	73	71	55	53	33	00	DRR
K0.8	49	46	44	42	45	44	43	41	75
1.0	51	48	47	45	48	46	46	44	80
1.5	54	52	50	49	51	50	49	48	86
2.0	56	54	53	52	53	52	52	50	91
2.5	57	56	55	54	55	54	53	52	94
3.0	57	57	56	55	56	55	54	53	96
4.0	58	58	57	57	57	56	55	54	98
5.0	59	58	58	58	57	57	56	55	99

Luminance curve limit

