

# LASER BLADE

DOWNLIGHT TRIM / TRIMLESS MODEL: ILB01 / 02 / 05 - TR / TL - NC - REM

GENERAL LIGHT TRIM MODEL: ILB05 - TR - NC - REM

WALL WASHER TRIM MODEL: ILB05 - TR / TL - NC - REM

## INSTRUCTIONS SHEET

PAGE: 1 of 3

**IMPORTANT** - READ CAREFULLY BEFORE INSTALLING FIXTURE. RETAIN THESE INSTRUCTIONS FOR FUTURE REFERENCE.

THIS PRODUCT MUST BE INSTALLED IN ACCORDANCE WITH THE NATIONAL ELECTRICAL CODE AND ALL APPLICABLE LOCAL CODES, BY A PERSON FAMILIAR WITH THE CONSTRUCTION AND OPERATION OF THE PRODUCT, AND THE HAZARDS INVOLVED. PROPER GROUNDING IS REQUIRED FOR SAFETY.

**⚠ DISCONNECT THE MAIN LINE BEFORE WIRING SECONDARY CONNECTORS.**

### NEW CONSTRUCTION PLASTER FRAME INSTALLATION (NC) - REMOTE DRIVER (REM)

A- ENGAGE (4) HANGER BARS IN HOUSING SLOTS AVAILABLE AND CONNECT THEM TOGETHER.

B- FASTEN HANGER BARS TO CEILING BRACE WITH #8 SCREWS (**NOT INCLUDED**). PLASTER FRAME MUST BE FLUSH WITH CEILING BRACE AND INSURE SMALL FOLDED TAB IS PLACED UNDER CEILING BRACE.

C- INSTALL DRYWALL AND MAKE THE CUT-OUT OPENING (**SEE DIMENSIONS BELOW**). LEAVE AT LEAST 6" (152mm) OF FEEDER CABLE ACCESSIBLE FROM UNDER THE CEILING.

**TRIMLESS MODEL:**

C- INSTALL DRYWALL AND MAKE THE CUT-OUT OPENING (**SEE DIMENSIONS BELOW**).

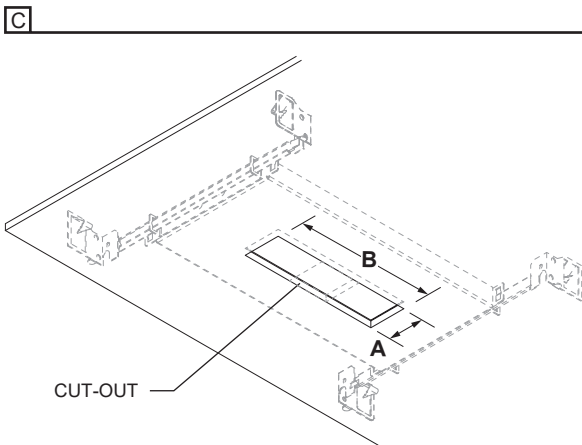
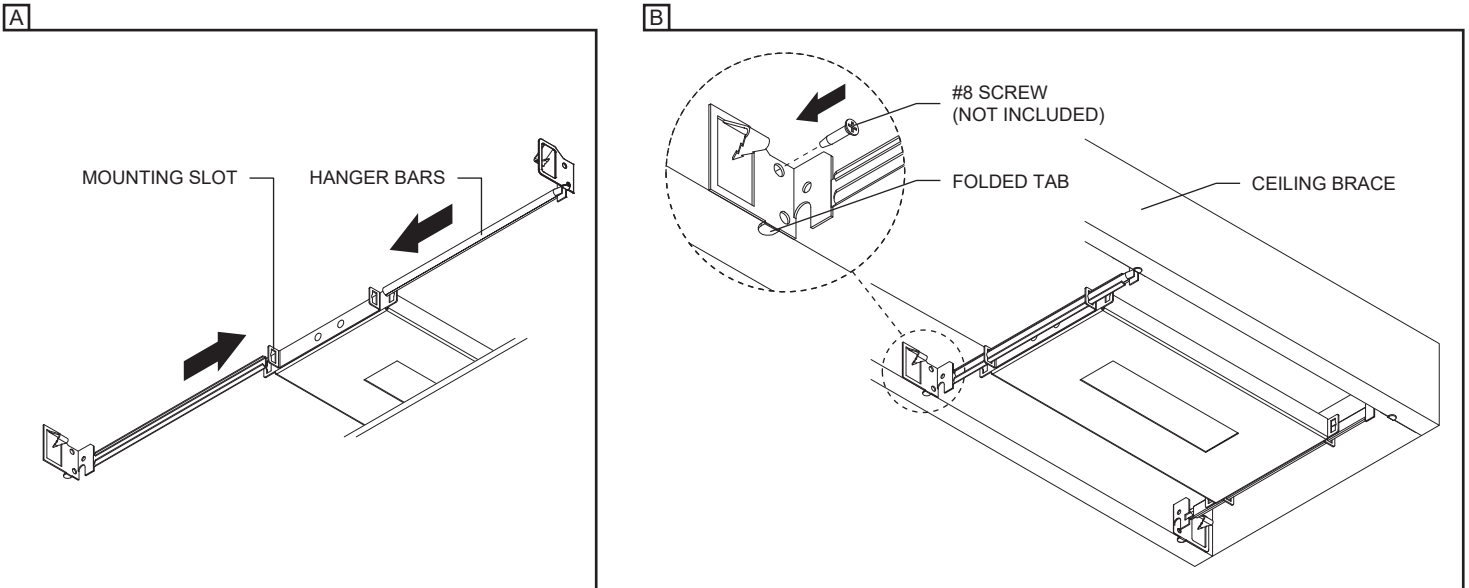

Model	Plaster Frame	Cut-out dimensions (A x B)	Ceiling thickness	Clearance
LB01	BN-LB01TR-NC	1 3/8" x 1 3/8" (35 x 35mm)	1/8"-1 1/8" (3-29mm)	2 1/2" (64mm)
	BN-LB01TL-NC		5/8" (16mm)	
LB02	BN-LB02TR-NC	1 3/8" x 2 1/2" (35 x 64mm)	1/8"-1 1/8" (3-29mm)	
	BN-LB02TL-NC		5/8" (16mm)	
LB05	BN-LB05TR-NC	1 1/2" x 5 1/2" (37 x 141mm)	1/8"-1 1/8" (3-29mm)	
	BN-LB05TL-NC	1 3/8" x 5 1/2" (35 x 141mm)	5/8" (16mm)	

# LASER BLADE

DOWNLIGHT TRIM / TRIMLESS MODEL: ILB01 / 02 / 05 - TR / TL - NC - REM

GENERAL LIGHT TRIM MODEL: ILB05 - TR - NC - REM

WALL WASHER TRIM MODEL: ILB05 - TR / TL - NC - REM

## INSTRUCTIONS SHEET

PAGE: 2 of 3

### TRIMLESS INSTALLATION ASSEMBLY FINISH

A- FINISH THE ASSEMBLY BY PLASTERING, SANDING AND PAINTING.

A

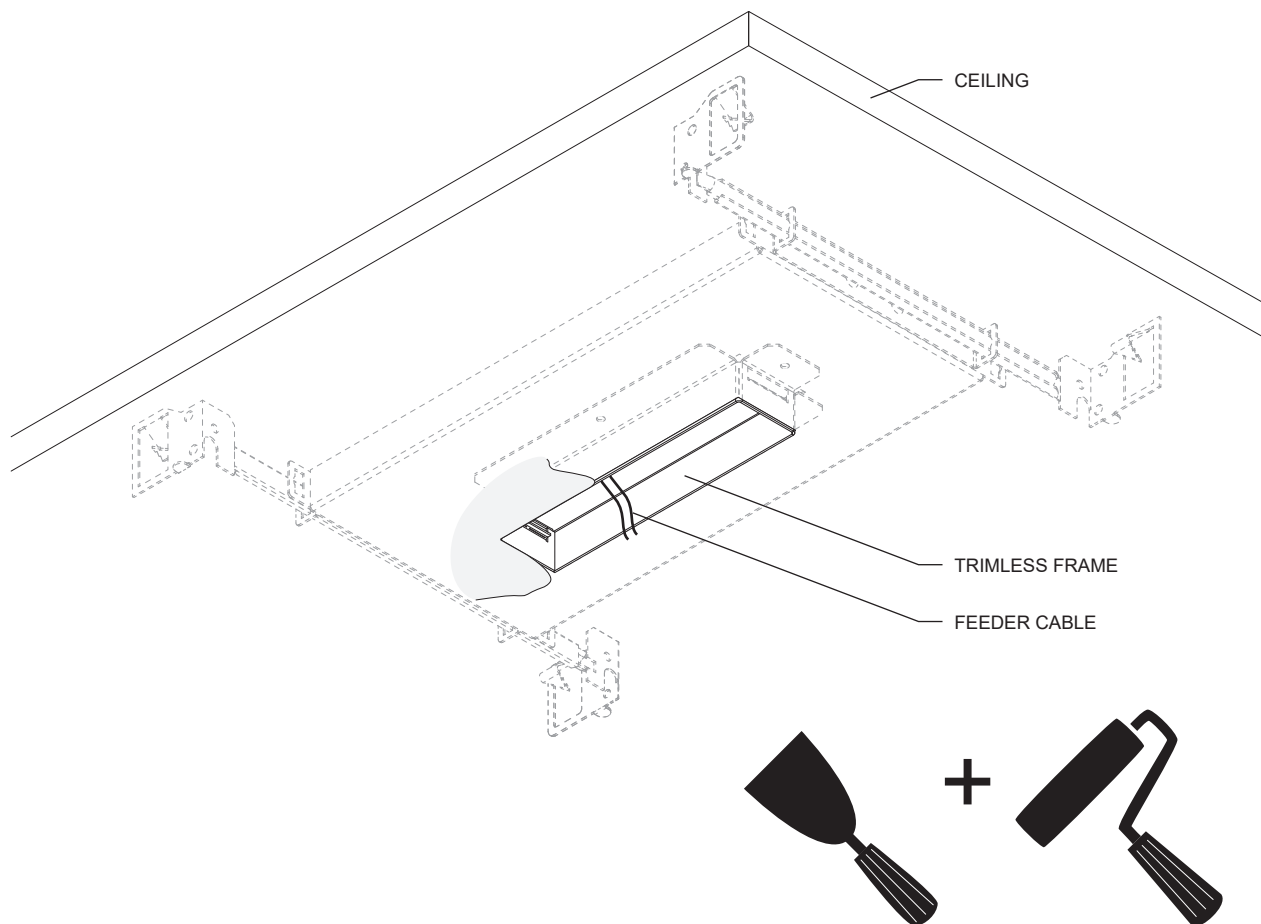

# LASER BLADE

DOWNLIGHT TRIM / TRIMLESS MODEL: ILB01 / 02 / 05 - TR / TL - NC - REM

GENERAL LIGHT TRIM MODEL: ILB05 - TR - NC - REM

WALL WASHER TRIM MODEL: ILB05 - TR / TL - NC - REM

## INSTRUCTIONS SHEET

PAGE: 3 of 3

### FIXTURE INSTALLATION

- A- MAKE ALL NECESSARY CONNECTIONS (**FOLLOWING WIRING DIAGRAM AND POLARITY MARKING**) USING THE QUICK CONNECTORS (**INCLUDED**).  
B- HOLD THE (2) CLIPS UPWARD AND INSERT FIXTURE INTO CUT-OUT.

#### TRIMLESS MODEL:

- B- HOLD THE (2) CLIPS UPWARD AND INSERT FIXTURE INTO CUT-OUT. ONCE INSERTED INTO THE FRAME, THE CLIPS SPRING BACK DOWN AND THE FRAME HOOKS WILL HOLD THE FIXTURE IN PLACE.

A + B

#### WIRING DIAGRAM

Multiple luminaires must be connected in series  
(home run or fixture chain)

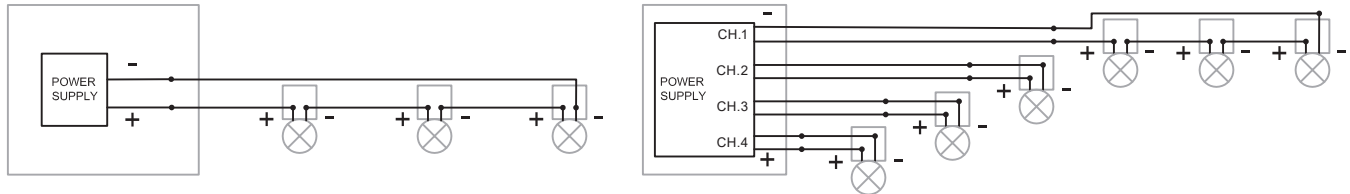

LED +	RED
LED -	BLACK

