

Last information update: May 2024

**Product configuration: 4826+L194**  
4826: Projector with electronic control gear 70 W HIT Spot

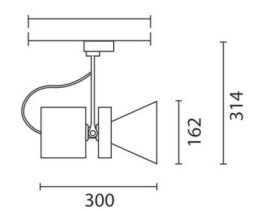
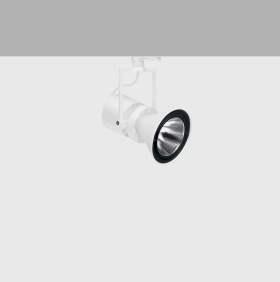

**Product code**

4826: Projector with electronic control gear 70 W HIT Spot **Attention! Code no longer in production**

**Technical description**

Die-cast aluminium and thermoplastic material projector with adapter. It can be rotated by 340° with respect to the vertical axis and inclined by +/- 100° with respect to the horizontal axis. Rotation and inclination movements may be locked mechanically to guarantee precise positioning of the light beam - also during maintenance operations. IP40 for optical assembly.

**Installation**

Track mounted or ceiling/wall mounted by special attachment to be ordered separately.

**Colour**

White (01) | Grey / Black (74)

**Mounting**

three circuit track

**Wiring**

Inside the fitting.

**Notes**

Complete with protection glass and capacitor.

Complies with EN60598-1 and pertinent regulations

850°C

IP20

IP40

for optical assembly

pending

**Technical data**

Im system:	4443	CRI (minimum):	88
W system:	78	Colour temperature [K]:	3000
Im source:	7300	Voltage [Vin]:	230
W source:	70	Lamp code:	L194
Luminous efficiency (Im/W, real value):	57	Socket:	G12
Im in emergency mode:	-	Number of lamps for optical assembly:	1
Total light flux at or above an angle of 90° [Lm]:	0	ZVEI Code:	HIT-CE
Light Output Ratio (L.O.R.) [%]:	61	Number of optical assemblies:	1
Beam angle [°]:	18°		

**Polar**

